

P-Primo

The Large Platform SMT Screen Printer



PERFORMANCE

Machine Alignment Capability	2Cmk @ ±12.5 microns 4 Sigma
Process Alignment Capability	2Cpk @ ±25 microns 4 Sigma
Core Cycle Time (excluding printing & cleaning time)	< 12 secs
Product Changeover Time	< 5 mins
New Product Set-up Time	< 10 mins

BOARD HANDLING

Max. Size (L x W)	850 mm x 610 mm
Min. Size (L x W)	100 mm x 65 mm
Thickness	0.4~8 mm
PCB Thickness Adjustment	Automatic
PCB Max. Weight	5 kg
PCB Edge Clearance	3.5 mm
PCB Bottom Clearance	23 mm
PCB Warpage	Max. 1% diagonally
Clamping Method	Retractable top clamp, motor controlled side clamp
Support Method	Magnetic support pins, bars, blocks, vacuum suction
Conveyor Direction	L to R, R to L, R to R, L to L (software control)
Conveyor Height	900 ± 40 mm
Conveyor Speed (max.)	1,500 mm/s
Conveyor Width Adjustment	Automatic

OPERATOR INTERFACE

Hardware	LCD Monitor, Mouse & Keyboard
Operating System (OS)	Windows 7 or Higher
Control Method	Industrial PC controlled
I/O Interface	SMEMA Standard

OPTICAL SYSTEM

Field-of-View (FOV)	8 mm x 6 mm
Fiducial Types	Circle, triangle, square, diamond, cross
Fiducial Size	0.5~4.0 mm
Vision Methodology	CCD camera look up & down
2D Inspection	Max. 100 windows to inspect missing & insufficient (std.)

PRINTING PARAMETERS

Stencil Frame Size (L x W)	Adjustable, 737 mm x 737 mm to 1,100 mm x 850 mm
Print Gap (snap-off)	0~20 mm
Printing Table Adjustment Range	X: ±10 mm, Y: ±10 mm/θ: ± 2°
Print Speed	5~150 mm/s
Squeegee Pressure	0.5~10kg (program control)
Squeegee Type	Std.: Metal, Option: Rubber
Squeegee Angle	Std. 60°, Option 45°, 50°, 55°
Cleaning System	Auto wet, dry, vacuum (Software select)

FACILITIES REQUIREMENT

Power Supply	AC220V ± 10% 50/60Hz
Power Consumption	3kW
Air Supply	4 ~ 6Kgf/cm ²
Dimension (excluding signal tower)	1,590 mm (L) x 1,608mm (W) x 1,530 mm (H)
Machine Weight	1,400 kg

OPTIONS

Stencil Apertures Inspection System
SPI Closed-Loop
Temperature, Humidity Monitoring & Display
External Barcode Scanner for PCB Traceability
Handheld Barcode Scanner for stencil, solder paste, squeegee traceability

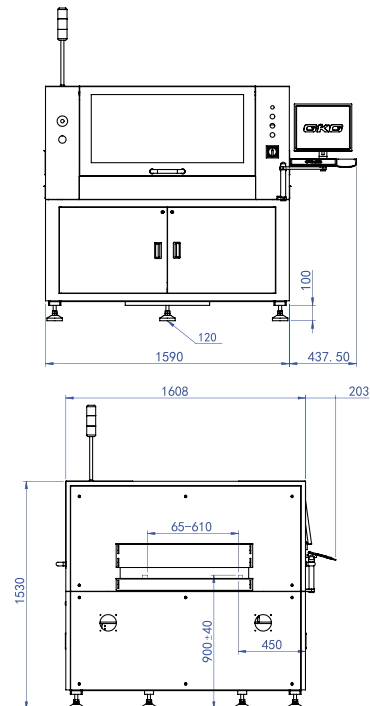

GKG®

GKG ASIA PTE LTD

Global Marketing & Training Centre
 Service & Spare Parts Support Centre
 52 Ubi Avenue 3, #02-38 Frontier, Singapore 408867
 Tel: +65 6547 8065 | Fax: +65 6547 5451
 www.gkgasia.com

GKG PRECISION MACHINE CO., LTD.

Manufacturing - R&D Centre
 No. 2 Shalang Road, Dong Cheng District Dongguan City
 Guangdong Province China
 Tel: +86 769 2276 7281, 3882 3222
 Fax: +86 769 3882 0799
 www.gkg.cn



©GKG, all rights reserved.

*GKG reserves the right to make any changes concerning design or specification of the machine without any prior notice for continuous improvement. (P-Primo Version 1.0 2017.07)